

## JANUARY 2010

AENA recently completed the regional office for Unlimited Care Inc., in Middletown, NY. This project included new construction to complete an addition to the existing one story office and retail building, renovation of interior spaces for the new uses, and landscape alterations to create common outdoor areas. AENA obtained all required approvals for the project including a complicated Planning Board and Building Department review process by providing all architectural, engineering, and landscape design as well as comprehensive design-build services.

The project was completed using a Cost Plus delivery method. This model accelerates the project by starting multiple facets of the projects simultaneously.

In our cost-plus method the customer is charged directly for the real costs of labor and material incurred in the project without other mark-ups. While AENA develops a timeline and a budget to assess the project, we do not bid or provide a fixed cost for construction. The customer gets cost savings because they do not incur any contingencies, cushion, or overhead that normally increases a bid number. The client also avoids costly errors in communication between the design and construction team and never sees a change order unless the scope of the project is truly changed. There are many other savings such as the time and cost in preparing the bid itself, reduction in managerial and accounting tasks, and elimination of the submittal and substitution process, making the project delivery efficient and without redundant costs. The project schedule is accelerated because the job is able to begin construction while design is still underway, thereby reducing carrying costs. AENA has the unique capabilities as a design-build firm to utilize expeditors, architects, and construction personnel during all phases of the design and construction process. We finalize the design and begin construction immediately after obtaining a permit, utilizing our integrated expediting services. Detailed project documentation is completed while construction is underway to save time. Unexpected field conditions are handled within budget by design solutions that have design and field personnel working together to find the best solution for unexpected conditions. The comprehensive cost savings of this delivery method are substantial. In a typical cost-plus design-build project, the entire project including all design, approvals, and construction is typically completed for 33% less than average renovation construction costs. This provides the clients who utilize these services with substantial savings as well as expedited delivery of their project. We believe this delivery method is truly the most cost effective way to complete any project while providing the same high level of design as other delivery methods.

### Cost Plus Advantages:

- Efficiency Of Design And Construction
- Accelerated Scheduling
- Lower Overhead Costs
- No Mark-Up Or Cushion In Pricing
- Increased Communication

AENA is capable of completing any project requirement and is a full service expert that can handle every aspect of the project. In the unique development project we completed for this client, AENA utilized a cost-plus delivery method along with our normal development services. By combining our cost-plus design-build model with our development services, AENA developed a partnership with this client throughout the lifespan of the project and beyond. As with any cost-plus project, there was no time wasted on negotiating a bid or change orders, and AENA became a true partner and advocate for the client in the project from the first design meeting through final touch-up.



Exterior view.



Exterior and interior views.



Exterior views.

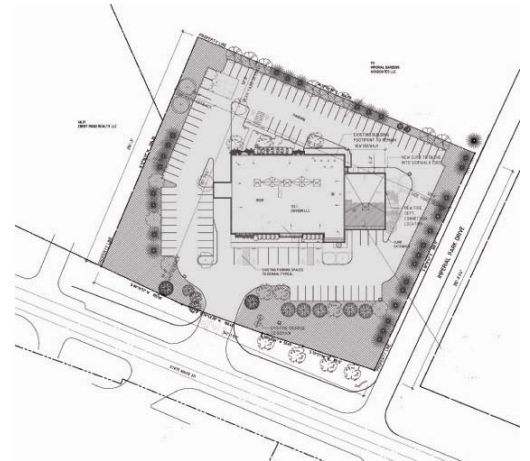

Site Plan.



### aena

144 East 44th Street  
New York, NY 10017

t 212 338 0111  
info@aenac.com  
www.aenac.com

37-24 24th Street  
Long Island City  
11101

Architecture  
Planning  
Interior Design  
Design Build